



SRINATH  
SHIKHAR

MANGO, JAMSHEDPUR

Luxurious



# LIVING

What's your definition for a luxury today?

Fun amenities to fill your leisure hours? A location that keeps you connected to every part of your city? Well thought & exceptional design with quality construction? Space where you can relax & rejuvenate?

At Srinath Shikhar all these little luxuries of urban life come together to give you the fine living experience you've been dreaming of all along!



**Block A To F - 495 Apartments**



**2 BHK & 3 BHK Flats - 910 sqft to 1375 sqft**



**Centrally located at Mango, Jamshedpur**



SRINATH  
SHIKHAR



Aerial View



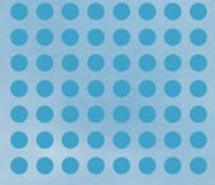

Garden View





# SRINATH SHIKHAR

Lifestyle Meets



# NATURE

Srinath Shikhar brings an auspicious life in Mango - Jamshedpur. Surrounded by greens with the highest standards of construction, refined lifestyle and the best of the world comes to pamper you with the finest of comforts & the grandest of luxury. Positive vibes elevates your joy.



MULTIPURPOSE HALL



PLAY AREA FOR CHILDREN



CLUB HOUSE



INDOOR GAMES



SHOPPING COMPLEX



JOGGER'S TRACK



SWIMMING POOL



COMMUNITY HALL



BADMINTON COURT



CENTRAL GARDEN





Lawn View







Play Zone







Pool View



# Site Plan

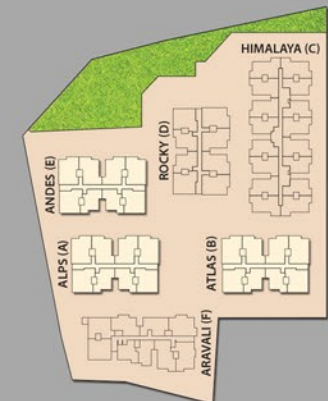

ALPS (A), ATLAS (B), ANDES (E)  
TYPICAL 1ST TO 9TH FLOOR

FLAT	BHK	CARPET AREA	BUA	SBUA
1 & 4	3	945 sqft	1146 sqft	1375 sqft
2 & 3	3	942 sqft	1102 sqft	1325 sqft
5 & 8	3	937 sqft	1078 sqft	1295 sqft
6 & 7	3	685 sqft	827 sqft	990 sqft



# Floor Plans

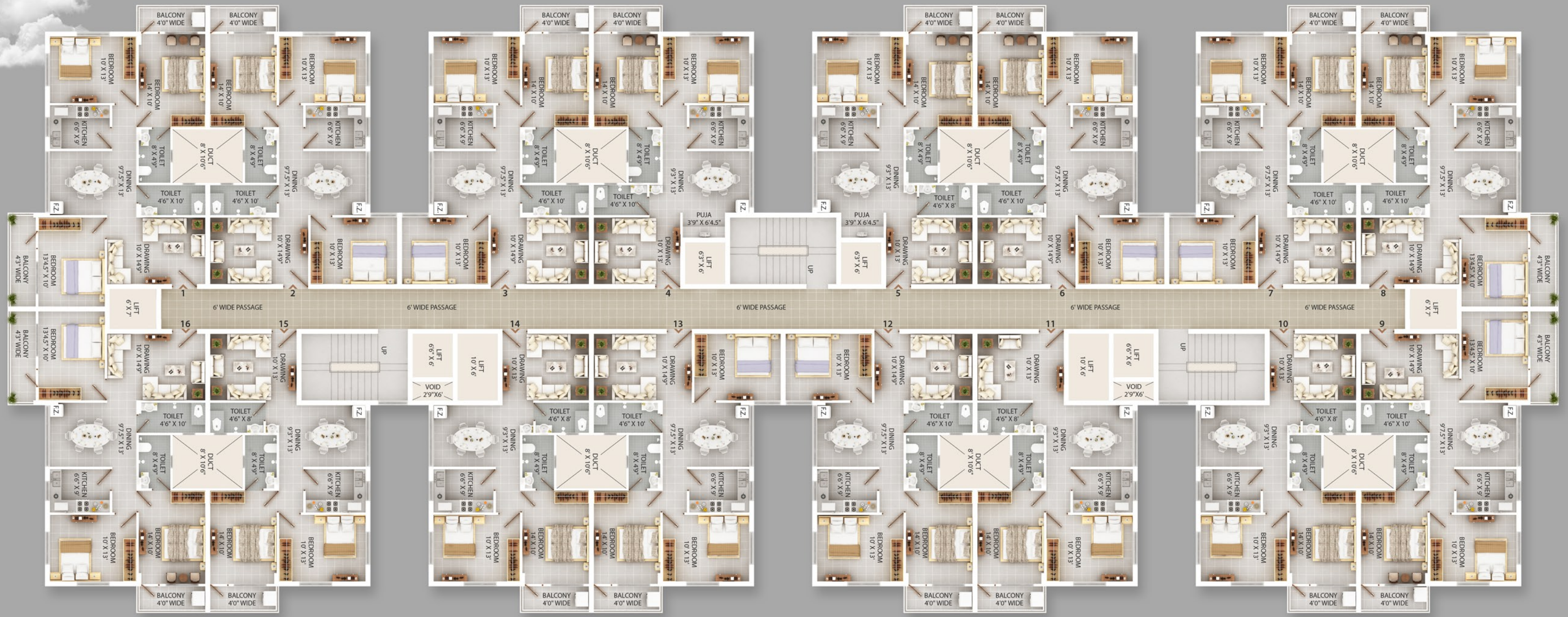

HIMALAYA (C)  
TYPICAL 1ST TO 9th FLOOR

FLAT	BHK	CARPET AREA	BUA	SBUA
1, 8, 9 & 16	3	880 sqft	1061 sqft	1275 sqft
2, 3, 6 & 7	2	876 sqft	1001 sqft	1200 sqft
4 & 5	2	742 sqft	864 sqft	1040 sqft
10, 11, 13, 14, & 15	2	717 sqft	839 sqft	1010 sqft

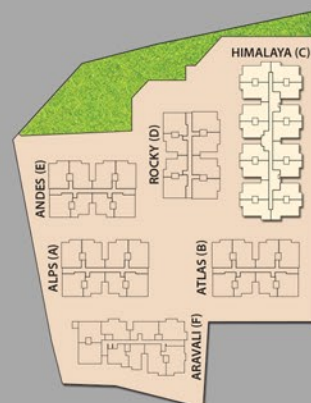

# Floor Plans



ROCKY (D)  
TYPICAL 1ST TO 9th FLOOR

FLAT	BHK	CARPET AREA	BUA	SBUA
1 & 4	3	945 sqft	1146 sqft	1375 sqft
2 & 3	3	942 sqft	1102 sqft	1325 sqft
5 & 8	3	937 sqft	1078 sqft	1295 sqft
6 & 7	3	685 sqft	827 sqft	990 sqft



ARAVALI (F)  
TYPICAL 1ST TO 9th FLOOR

FLAT	BHK	CARPET AREA	BUA	SBUA
1	3	856 sqft	1031 sqft	1240 sqft
2	3	864 sqft	1007 sqft	1210 sqft
3	3	868 sqft	1003 sqft	1205 sqft
4	3	908 sqft	1102 sqft	1320 sqft
5	3	952 sqft	1144 sqft	1375 sqft
6	3	957 sqft	1092 sqft	1310 sqft
7	2	640 sqft	758 sqft	910 sqft
8	2	649 sqft	762 sqft	915 sqft
9	3	862 sqft	1037 sqft	1245 sqft

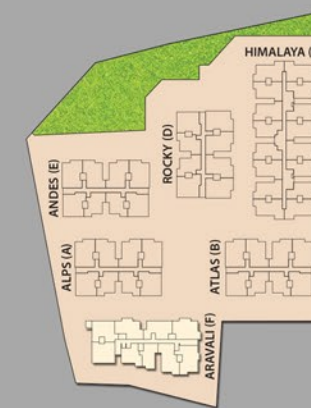
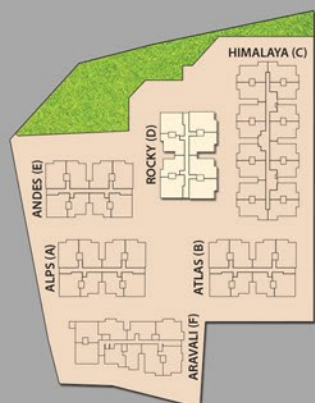

# Isometric Views

ALPS (A), ATLAS (B)  
ROCKY (D) & ANDES (E)

**FLAT 1**  
BLOCK A, B, D & E  
SBUA 1375 sqft  
BHK 3



**FLAT 1**  
BLOCK A, B, D & E  
SBUA 1375 sqft  
BHK 3



**FLAT 2**  
BLOCK A, B, D & E  
SBUA 1325 sqft  
BHK 3

**FLAT 2**  
BLOCK A, B, D & E  
SBUA 1325 sqft  
BHK 3



**FLAT 7**  
BLOCK A, B, D & E  
SBUA 990 sqft  
BHK 3



**FLAT 7**  
BLOCK A, B, D & E  
SBUA 990 sqft  
BHK 3



**FLAT 8**  
BLOCK A, B, D & E  
SBUA 1295 sqft  
BHK 3

**FLAT 8**  
BLOCK A, B, D & E  
SBUA 1295 sqft  
BHK 3



# Isometric Views

HIMALAYA (C)

**FLAT 5**  
BLOCK C  
SBUA 1040 sqft  
BHK 2



**FLAT 7**  
BLOCK C  
SBUA 1200 sqft  
BHK 2

**FLAT 8**  
BLOCK C  
SBUA 1275 sqft  
BHK 3



**FLAT 10**  
BLOCK C  
SBUA 1010 sqft  
BHK 2

**FLAT 5**  
BLOCK C  
SBUA 1040 sqft  
BHK 2



**FLAT 7**  
BLOCK C  
SBUA 1200 sqft  
BHK 2

**FLAT 8**  
BLOCK C  
SBUA 1275 sqft  
BHK 3



**FLAT 10**  
BLOCK C  
SBUA 1010 sqft  
BHK 2

# Unit Plans

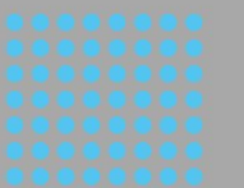



Balcony View



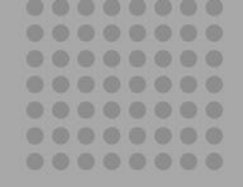

# Location Map

## At Srinath Shikhar

Joy is in the Air



# SRINATH SHIKHAR

### KEY DISTANCES

TMH Hospital - 5 Kms | Mango Bus Srand - 500 Mtrs | Payal Cinema - 1 Km | Eyelex - 2.5 Kms  
 Tata Steel Sakchi Gate-1.5 Kms | Market - 0.5 Km | School - 1 Km | Petrol Pump - 0 Km







Gate View



SRINATH  
SHIKHAR



A Project by  
**SRINATH HOMES**



# Specifications

## WALL FINISH

**Internal :** Internal walls will be plastered and then Plaster of Paris.

**External :** Exquisitely designed exteriors finished in sandtexmaatt / Snowcem.

## FLOORING

**Drawing / Dining :** Complete vetrified tiles flooring 2'X2' in with 6" high skirting.

**Bedroom : Balcony :** Complete vetrified tiles flooring 2'X2' in with 6" high skirting and granite border will be given in every separated door area.



## TOILET

**Walls :** Ceramic tiles up to a height of 7'.

**Flooring :** Anti skid ceramic tiles size min.12"X12".

**Fittings :** Wash basin with full pedestal & dining wash basin is half pedestal, in dining wash basin mixture with Hot & Cold water supply & 2'X6' std. tiles in above wash basin and washing machine area will be completely covered with tiles till 7' height, Provision of mirror, towel rail, soap dish and cold and hot water supply in master toilet only & pipe line connect in common toilet also system with CP fittings of standard make.



## KITCHEN

**Flooring :** Complete vetrified tiles flooring 2' x 2' in with 6" high skirting provided.

**Platform :** A working platform will be of black granite top with stainless steel kitchen. Sink. 6' PVC pipe will have grout in wall for chimney in kitchen.

**Wall:** 2ft. high white glaze tiles on Dado size 12"X18" above working platform.



## SANITARY WARE

Master bedroom bathroom commode side 2 in 1 bib cock with health faced provided and vitreous white ceramic sanitary ware of standard makes. Cistern will be given of PVC.

## WINDOW

All window i.e., bedroom, kitchen, toilet will have UPVC and taffend glasses. Balcony window will have full opening and 7'0" height i.e., three track window. All window seal will have green marble.

## DOOR

Front door frame or choukhet will be wooden and laminate with choukhet border and door both. Rest door will be same but choukhet will be of steel and laminated with border.

## ELECTRICITY

All units will have individual meter. An extra cost will be charged for the electricity connection.

## WATER SUPPLY

Round the clock supply of water with overhead tanks and deep tube well.

## GENERATOR

Suitable capacity to provide 300 watts emergency supply to each flats.

## TELEPHONE / TV POINT

In drawing / dining room and master bedroom.

## DOOR LOCKS

All bedroom and entrance door will have mortised lock and toilet lock will be of cylindrical latch.



## ELECTRICAL WORK

**Each Bedroom :** 2 light points, 1 fan point, 1 plug point, 1 AC point, 1.5 amp switch & socket will have on the both sides of the bed.

**Kitchen :** 1 light points, 1. ex. fan point, 2 power plug points, 1.15 amp plug point.

**Master Bedroom :** 3 light points, 1 fan point, 1 plug point, 1 AC point, 1 T.V. point, 1.5 amp switch & socket will have on the both sides of the bed.

**Balcony :** 1 light point

**Dinning & Living Room :** 4 light points, 3 fan points, 1 plug point, 1 TV point, 2.5 amp switch & socket near TV point.

**Toilet :** 2 light points, 1 ex. fan point, 1 plug point, 1 geyser plug point (attach) & pipe line connect in common toilet also. 1.5 amp point near wash basin in all toilets.

## N.B.

1. All specification, size & layout are subject to variation without any notice.
2. Any alteration / modification or extra facility demanded by the customer will be only be accepted if permissible by our architect.
3. Any addition / modification or extra facility demanded by the customer will be charged extra.

## DEVELOPERS



### SRINATH HOMES INDIA PVT. LTD.

112, 1st Floor, Ashiana Trade Centre  
Adityapur-1, Jamshedpur - 831013, Jharkhand (INDIA)  
+91 9234607628 / +91 8235051210  
srinathhomes@gmail.com | www.srinathhomes.com

### SITE ADDRESS

#### Srinath Shikhar

Chanakyapuri, Old Purulia Road  
Mango - 831012, Jamshedpur, Jharkhand



## CONSULTANTS

### AAKRITI CONSULTANTS

19B, Tulsi Bhawan  
Opp. Gopal Maidan  
Bistupur, Jamshedpur - 831001  
0657 - 2249123 / 2249581  
atc@aakritigroups.com

### DISCLAIMER

This brochure is not a legal document. It describes the conceptual plan to convey the intent and purpose of Srinath Shikhar. The images are imaginary and the details mentioned in this brochure are tentative and subject to change at the sole discretion of the developer and /or architects.